

PREFINAL
PLANS

FOR INDEX OF SHEETS, SEE SHEET NO. 2

THIS PROJECT IS LOCATED WITHIN
VILLAGE OF WINNETKA

Ciorba Group, Inc.

DESIGN FIRM
REGISTRATION NUMBER

184-001016

CONSULTING ENGINEERS
8725 W. HIGGINS RD, SUITE 600
CHICAGO, ILLINOIS 60631 :: (773) 775-4009

TRAFFIC DATA

FOREST WAY DRIVE:
FUNCTIONAL CLASSIFICATION
LOCAL STREET
ADT (2022) = 2,400
POSTED SPEED LIMIT = 40 MPH

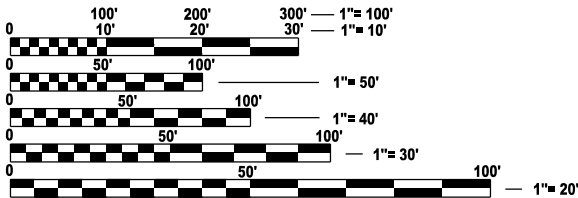

FULL SIZE PLANS HAVE BEEN PREPARED USING STANDARD
ENGINEERING SCALES. REDUCED SIZED PLANS WILL NOT
CONFORM TO STANDARD SCALES. IN MAKING MEASUREMENTS
ON REDUCED PLANS, THE ABOVE SCALES MAY BE USED.

J.U.L.I.E.
JOINT UTILITY LOCATION INFORMATION FOR EXCAVATION
1-800-892-0123
OR 811

PROJECT MANAGER: PRAVEEN KAINI

CONTRACT NO. 62W72

STATE OF ILLINOIS
DEPARTMENT OF TRANSPORTATION

PROPOSED
HIGHWAY PLANS

CH 92W/FOREST WAY DRIVE (NORTH OF WILLOW ROAD)
REMOVAL AND REPLACEMENT OF CULVERT
OVER THE DITCH
SECTION: (048-112-15D) CR 24
PROJECT: HBFP-OFF-S-HTN4(633)
COOK COUNTY

C-91-207-24

NORTHFIELD
TOWNSHIP

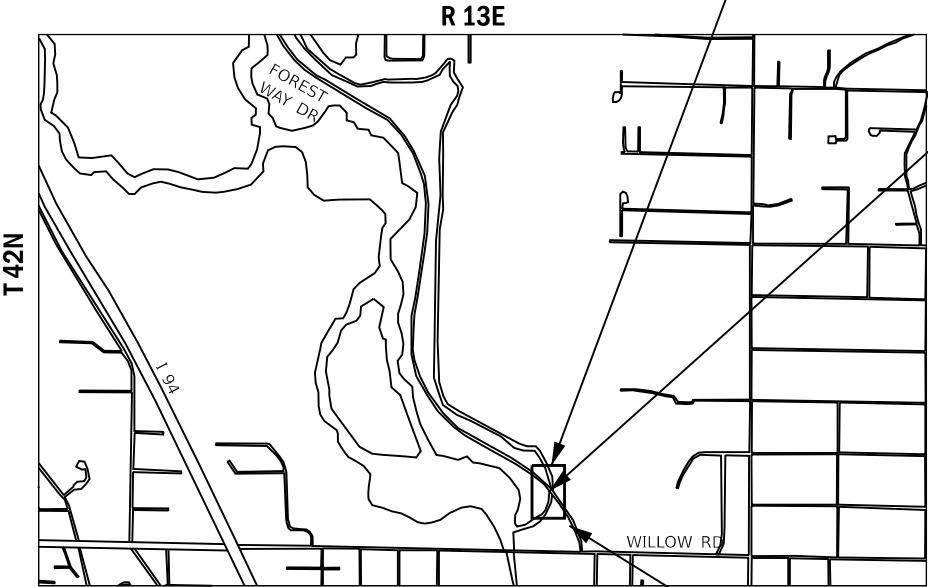

GROSS LENGTH = 736 FT. = 0.139 MILE
NET LENGTH = 736 FT. = 0.139 MILE

PROJECT BEGINS
STA.44+64

EX SN 016-2309
PR SN 016-8305
STA. 49+99.89



PROJECT ENDS
STA.52+00

| F.A.P. RTE. | SECTION | COUNTY | TOTAL SHEETS | SHEET NO. |
|----------------|---------------------|----------|--------------------|--------------|
| 92W | (048-112-15D) CR 24 | COOK | 46 | 1 |
| | | ILLINOIS | CONTRACT NO. 62W72 | |

D-91-174-24



STATE OF ILLINOIS
DEPARTMENT OF TRANSPORTATION

SUBMITTED 20

REGIONAL ENGINEER

20

ENGINEER OF DESIGN AND ENVIRONMENT

20

DIRECTOR OF HIGHWAYS PROJECT IMPLEMENTATION

PRINTED BY THE AUTHORITY
OF THE STATE OF ILLINOIS

DATE PLOTTED = 9/5/2025 1:45:20 PM
PEN TABLE = 0021693.08.tbl
PLOT CONFIG = CDPLOT.plt
PLOT FILE = Proj\CDR\62W72\62W72.dgn
PLOT SCALE = 8.333' / in.
PLOT DATE = 8/19/2025



| | | |
|---------------------------|----------------|-----------|
| USER NAME = askoniccki | DESIGNED TBH | REVISED - |
| DRAWN AS | DRAWN AS | REVISED - |
| PLOT SCALE = 8.333' / in. | CHECKED NF | REVISED - |
| PLOT DATE = 8/19/2025 | DATE 7/25/2025 | REVISED - |

STATE OF ILLINOIS
DEPARTMENT OF TRANSPORTATION

FOREST WAY DRIVE OVER DITCH
PROPOSED TYPICAL SECTIONS

SCALE: SHEET OF SHEETS STA. TO STA.

| F.A.P. RTE. | SECTION | COUNTY | TOTAL SHEETS | SHEET NO. |
|---------------------------|--------------------|--------|--------------|-----------|
| 0092 | (048-112-15D) CR24 | COOK | 46 | 9 |
| CONTRACT NO. 62W72 | | | | |
| ILLINOIS FED. AID PROJECT | | | | |

NOTE: SUBGRADE DEPTH VARIES OVER CULVERT.
SEE STRUCTURAL PLANS FOR MORE DETAIL.

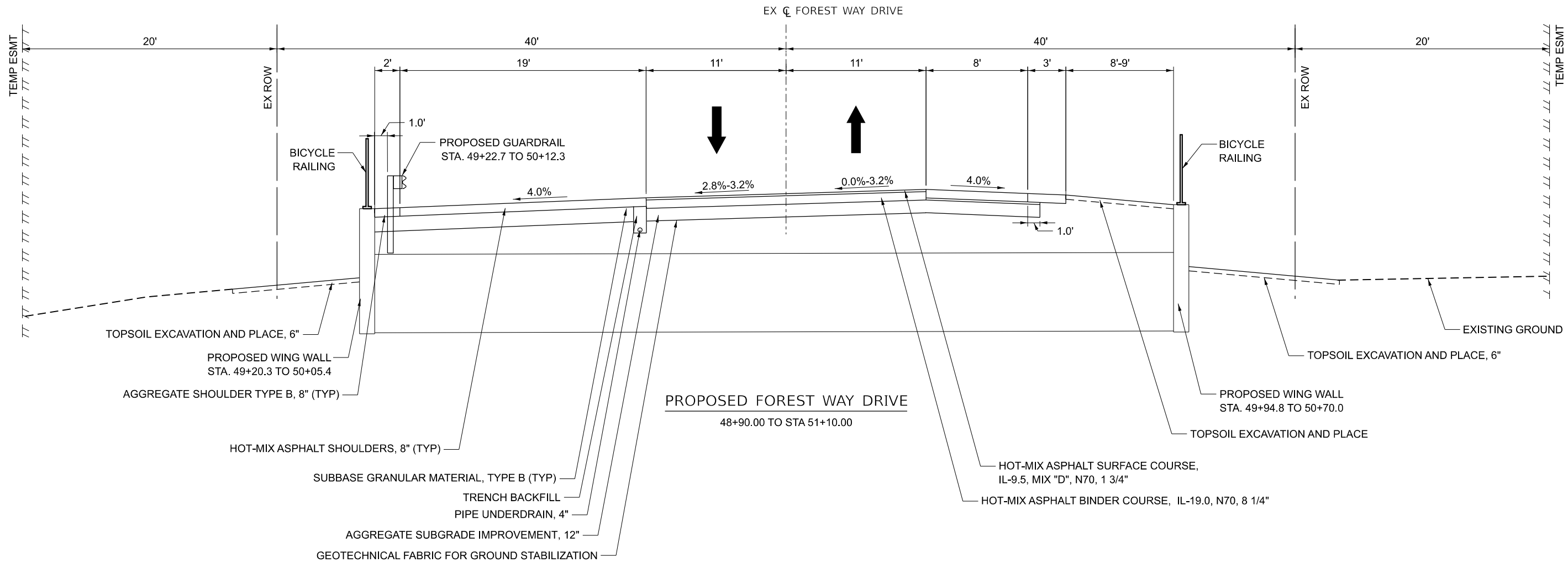

NOTES

- SIGN 1 AND 2 COVERING SHALL BE PLACED ONE (1) WEEK PRIOR TO CLOSURE. REMOVE SIGN 3 ONCE DETOUR BEGINS. THESE SIGNS SHALL BE PAID FOR AS TEMPORARY INFORMATION SIGNING.
- THE CONTRACTOR SHALL CALL J.U.L.I.E. BEFORE INSTALLING SIGNS.
- ROAD CLOSURE SIGNAGE SHALL NOT BE INSTALLED ON ANY STREET LIGHT POLES OR SIGNAL POLES.
- ROAD CLOSURE SIGNAGE SHALL NOT BLOCK ANY EXISTING SIGNS AND CANNOT USE THE EXISTING SIGN POSTS.
- TYPE III BARRICADE PLACEMENT SHALL FOLLOW HIGHWAY STANDARD 701901.
- SIGN SPACING SHALL FOLLOW DISTRICT 1 DETAIL TC-21 UNLESS NOTED ON PLAN.
- PLAN NOT TO SCALE.
- THE CONTRACTOR SHALL NOT OBSTRUCT ANY EXISTING SIGN WITH THE PLACEMENT OF DETOUR SIGNAGE.
- TEMPORARY ACCESS SPEC SHALL BE REFERENCED TO MAINTAIN ACCESS TO THE NORTH BRANCH TRAIL SYSTEM DURING CONSTRUCTION.
- DETOUR SIGNAGE & ALL RELATED DETOUR TRAFFIC CONTROL ITEMS SHALL BE CONSIDERED INCLUDED IN THE COST FOR DETOUR SIGNAGE (EXCEPT AS OTHERWISE NOTED)

NORTHBOUND
Forest Way Drive
BRIDGE CLOSED
FOLLOW DETOUR

SOUTHBOUND
Forest Way Drive
BRIDGE CLOSED
FOLLOW DETOUR

60"X48"
6" BLACK LETTERS ON
ORANGE REFLECTIVE
BACKGROUND

60"X48"
6" BLACK LETTERS ON
ORANGE REFLECTIVE
BACKGROUND

DETOUR
AHEAD

BEGINS MM/DD/YYYY

NORTH
Forest Way Dr.
DETOUR
↑

NORTH
Forest Way Dr.
DETOUR
↙

NORTH
Forest Way Dr.
DETOUR
↘

Forest Way Dr.
W20-2-2418
5" BLACK LETTERS ON
FLUORESCENT ORANGE
BACKGROUND

M4-9-3024

M4-9L-3024

M4-9R-3024

NORTH
Forest Way Dr.
DETOUR
←

NORTH
Forest Way Dr.
DETOUR
→

SOUTH
Forest Way Dr.
DETOUR
↑

SOUTH
Forest Way Dr.
DETOUR
↙

SOUTH
Forest Way Dr.
DETOUR
↘

M4-9L-3024

M4-9R-3024

M4-9-3024

M4-9L-3024

M4-9R-3024

SOUTH
Forest Way Dr.
DETOUR
←

END
DETOUR

ROAD
CLOSED

ROAD CLOSED
1 MILE AHEAD
LOCAL TRAFFIC ONLY
DETOUR
→

ROAD CLOSED
1 MILE AHEAD
LOCAL TRAFFIC ONLY

M4-9L-3024

M4-8a
24"X18"

R11-2
48"X30"

R11-3a-6030
M4-10R-4818

R11-3a-6030

ROAD
CLOSED
500 FT

ROAD
CLOSED
AHEAD

ROAD
CLOSED

DETOUR
←

NO RIGHT TURN

NO LEFT TURN

W20-3-4848

W20-3-4848

R11-2-4830
M4-10L-4818

M4-10L-4818

R3-1-30

R3-2-30

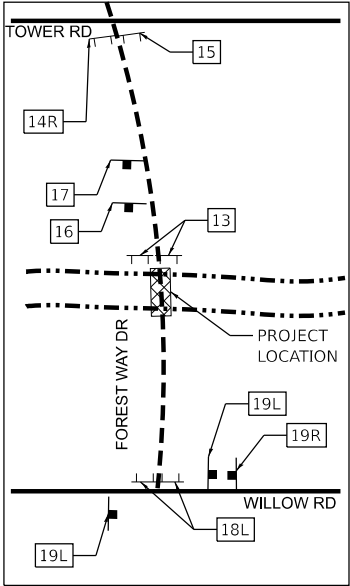
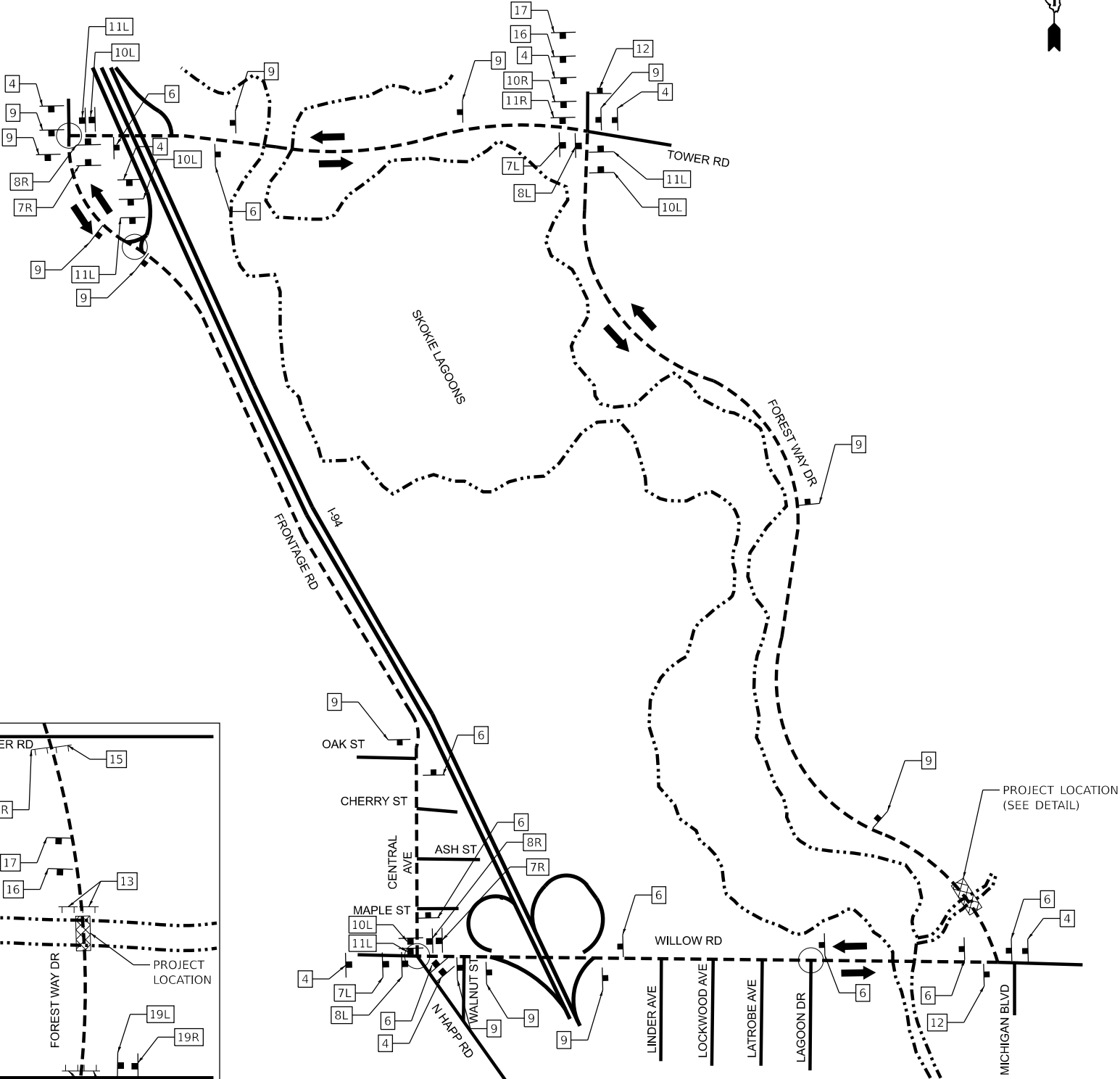

PROJECT LOCATION DETAIL

LEGEND

- PROPOSED VEHICLE DETOUR ROUTE
- DETOUR SIGN POST-MOUNTED PER ARTICLE 701.14 AND HIGHWAY STANDARD 701901
- TEMPORARY TRAFFIC SIGNAL TIMING REQUIRED
- TYPE III BARRICADE WITH FLASHERS
- PROJECT LOCATION

DATE PLOTTED = 9/4/2025 4:20:05 PM
PEN TABLE = 0021693.08.tbl
PLOT CONFIG = C:\PDR\pdrfig
PROJECT = 8725 W. Higgins Rd, Ste 600, Chicago, IL 60631
FILE NAME = p:\proj\003-1693-08\CADD Data\Sheet\0762W72-sht-Detour.dgn



| | | |
|----------------------------|----------------|-----------|
| USER NAME = askonic1 | DESIGNEDTBH | REVISED - |
| PLOT SCALE = 40,000' / in. | DRAWN AS | REVISED - |
| PLOT DATE = 8/19/2025 | CHECKED NF | REVISED - |
| | DATE 7/25/2025 | REVISED - |

STATE OF ILLINOIS
DEPARTMENT OF TRANSPORTATION

FOREST WAY DRIVE OVER DITCH
FOREST WAY DRIVE DETOUR PLAN

SCALE: N.T.S. SHEET 1 OF 1 SHEETS STA. TO STA.

| F.A.P RTE. | SECTION | COUNTY | TOTAL SHEETS | SHEET NO. |
|---------------------------|--------------------|--------|-----------------|--------------|
| 0092 | (048-112-15D) GR24 | COOK | 46 | 14 |
| CONTRACT NO. 62W72 | | | | |
| ILLINOIS FED. AID PROJECT | | | | |

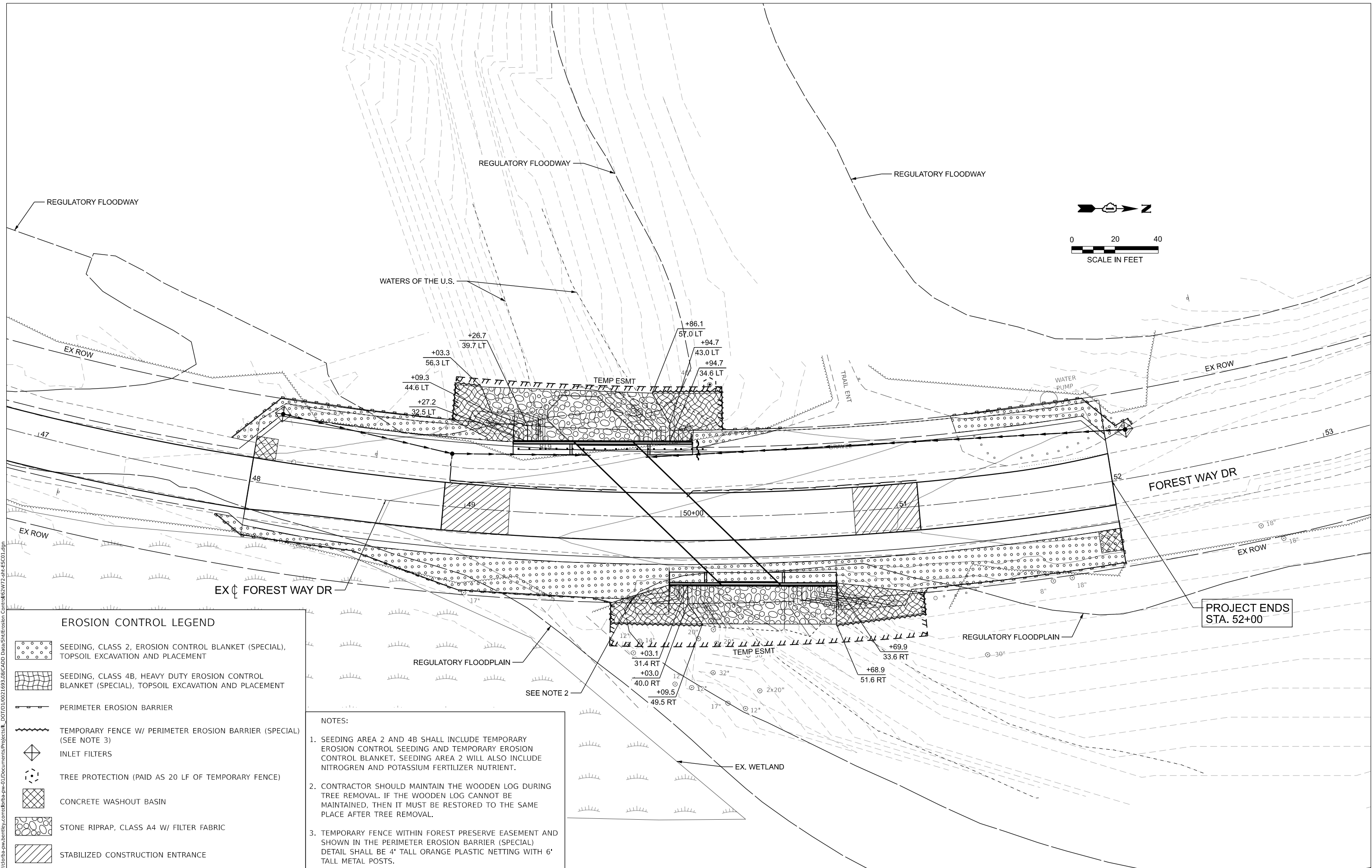

| | | |
|--------------------------------|----------------|-----------|
| USER NAME = askonicki | DESIGNEDTBH | REVISED - |
| | DRAWN AS | REVISED - |
| PLOT SCALE = 0.16666666" / in. | CHECKED NF | REVISED - |
| PLOT DATE = 8/19/2025 | DATE 7/25/2025 | REVISED - |

| | | | | | |
|---------------|-------|----|--------|---------------|------------------|
| SCALE: 1"=20' | SHEET | OF | SHEETS | STA. 47+00.00 | TO STA. 53+00.00 |
|---------------|-------|----|--------|---------------|------------------|

| | | | | |
|---------------|--------------------|--------------------|-----------------|--------------|
| F.A.P RTE. | SECTION | COUNTY | TOTAL SHEETS | SHEET NO. |
| 0092 | (048-112-15D) CR24 | COOK | 46 | 16 |
| | | CONTRACT NO. 62W72 | | |
| ILLINOIS | | FED. AID PROJECT | | |

DATE PLOTTED = 9/4/2025 4:20:41 PM
PEN TABLE = 0021693.08.tbl
PLOT CONFIG = C:\PLOT\PCCFG
PROJECT FILES: S:\01\DEL\NAMES
FILE NAME: P:\2\CD\B&P\Bentley.com\ciorba-pw-D\Documents\projects\ILL_DOT\DI\0021693.08\CADD Data\SiteErosion Control\0021693.07_62W7D-SHT-ESC-DET-01.dgn



8725 W. Higgins Rd, Ste 600, Chicago, IL 60631
P 773.775.4009 | www.ciorba.com

SOIL EROSION AND SEDIMENT CONTROL NOTES

1. NO WORK SHALL BE PERFORMED IN FLOWING WATER. WORK IN OR NEAR THE CRITICAL AREAS SHOULD BE ISOLATED FROM CONCENTRATED FLOWS OR STREAM FLOW. ONCE WORK IN THIS AREA BEGINS, PRIORITY SHALL BE GIVEN TO THE COMPLETION OF THE WORK AND FINAL STABILIZATION OF ALL DISTURBED AREAS.
2. SOIL DISTURBANCE SHALL BE CONDUCTED IN SUCH A MANNER AS TO MINIMIZE EROSION. AREAS OF THE DEVELOPMENT SITE THAT ARE NOT TO BE GRADED SHALL BE PROTECTED FROM CONSTRUCTION TRAFFIC OR OTHER DISTURBANCE UNTIL FINAL SEEDING IS PERFORMED.
- 3.PROPERTIES AND CHANNELS ADJOINING THE DEVELOPMENT SITE SHALL BE PROTECTED FROM EROSION AND SEDIMENTATION.
4. SOIL EROSION AND SEDIMENT CONTROL FEATURES SHALL BE INSTALLED PRIOR TO THE COMMENCEMENT OF HYDROLOGIC DISTURBANCE OF UPLAND AREAS.
5. DISTURBED AREAS SHALL BE STABILIZED WITH TEMPORARY OR PERMANENT MEASURES WITHIN SEVEN (7) CALENDAR DAYS FOLLOWING THE END OF ACTIVE HYDROLOGIC DISTURBANCE.
- 6.IF DEWATERING SERVICES ARE USED, ADJOINING PROPERTIES AND DISCHARGE LOCATIONS SHALL BE PROTECTED FROM EROSION. DISCHARGES SHALL BE ROUTED THROUGH AN EFFECTIVE SEDIMENT CONTROL MEASURE (E.G. SEDIMENT TRAP, SEDIMENT BASIN, OR OTHER APPROPRIATE MEASURES).
- 7.ALL TEMPORARY SOIL EROSION AND SEDIMENT CONTROL MEASURES SHALL BE REMOVED WITHIN THIRTY (30) DAYS AFTER FINAL SITE STABILIZATION IS ACHIEVED OR AFTER THE TEMPORARY MEASURES ARE NO LONGER NEEDED. TRAPPED SEDIMENT AND OTHER DISTURBED SOIL AREAS SHALL BE STABILIZED.
8. SOIL STOCKPILES SHALL NOT BE LOCATED IN FLOOD-PRONE AREAS OR A DESIGNATED BUFFER PROTECTING WATERS OF THE UNITED STATES OR ISOLATED WETLANDS.
9. CLEANING OF VEHICLES AND EQUIPMENT SHALL BE PERFORMED IN A MANNER TO REDUCE THE AMOUNT OF POLLUTANTS TRIBUTARY TO STORM SEWERS AND OPEN WATERS TO THE MAXIMUM EXTENT POSSIBLE.
10. ALL NECESSARY MEASURES SHALL BE TAKEN TO CONTAIN ANY FUEL OR POLLUTION RUNOFF. LEAKY EQUIPMENT OR SUPPLIES SHALL BE IMMEDIATELY REPAIRED OR REMOVED FROM THE SITE.
11. CONTRACTOR SHALL PROVIDE AN INSTREAM WORK PLAN FOR REVIEW BY THE RESIDENT ENGINEER AND WRITTEN APPROVAL BY BOTH THE ARMY CORPS AND NORTH COOK COUNTY SOIL AND WATER CONSERVATION DISTRICT (NCCSWCD) PRIOR TO STARTING ANY IN-STREAM WORK.
12. THE PORTION OF THE SIDE SLOPE THAT IS ABOVE THE OBSERVED WATER ELEVATION SHALL BE STABILIZED AS SPECIFIED IN THE PLANS PRIOR TO ACCEPTING FLOWS. THE SUBSTRATE AND TOE OF SLOPE THAT HAS BEEN DISTURBED DUE TO CONSTRUCTION ACTIVITIES SHALL BE RESTORED TO PROPOSED OR PRE-CONSTRUCTION CONDITIONS AND FULLY STABILIZED PRIOR TO ACCEPTING FLOWS.
13. UNLESS OTHERWISE INDICATED, ALL VEGETATIVE AND STRUCTURAL EROSION AND SEDIMENT CONTROL PRACTICES WILL BE CONSTRUCTED TO THE STANDARDS AND SPECIFICATIONS IN THE ILLINOIS URBAN MANUAL, LATEST EDITION.
14. THE NORTH COOK COUNTY SOIL AND WATER CONSERVATION DISTRICT (NCCSWCD) MUST BE NOTIFIED ONE WEEK PRIOR TO THE PRE-CONSTRUCTION MEETING, ONE WEEK PRIOR TO THE COMMENCEMENT OF LAND DISTURBING ACTIVITIES, AND ONE WEEK PRIOR TO THE FINAL INSPECTION.
15. A COPY OF THE APPROVED EROSION AND SEDIMENTATION CONTROL PLAN SHALL BE MAINTAINED AT THE SITE AT ALL TIMES.
16. PRIOR TO COMMENCING LAND-DISTURBING ACTIVITIES IN AREAS OTHER THAN INDICATED ON THESE PLANS, A SUPPLEMENTARY EROSION CONTROL PLAN SHALL BE SUBMITTED FOR REVIEW BY THE NCCSWCD.
17. THE CONTRACTOR IS RESPONSIBLE FOR THE INSTALLATION OF ANY ADDITIONAL EROSION CONTROL MEASURES NECESSARY TO PREVENT EROSION AND SEDIMENTATION AS DETERMINED BY THE NCCSWCD, AND THE ARMY CORPS.
18. DURING DEWATERING OPERATIONS, WATER WILL BE FILTERED, OR PUMPED INTO SEDIMENT BASINS OR SILT TRAPS. DEWATERING DIRECTLY INTO STREAMS, WETLANDS, FIELD TILES, OR STORMWATER STRUCTURES IS PROHIBITED.
19. IT IS THE RESPONSIBILITY OF THE LANDOWNER AND/OR GENERAL CONTRACTOR TO INFORM ANY SUB-CONTRACTOR(S), WHO MAY PERFORM WORK ON THIS SITE/PROJECT, OF THE REQUIREMENTS IN IMPLEMENTING AND MAINTAINING THESE EROSION CONTROL PLANS AND ASSURE COMPLIANCE WITH ALL APPLICABLE LOCAL, STATE, AND FEDERAL REGULATIONS.

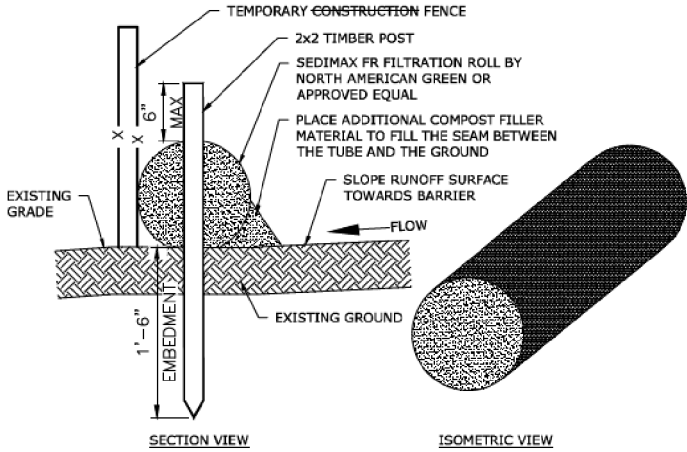

- NOTES:
1. PERIMETER EROSION CONTROL BARRIER SHALL BE INSTALLED PRIOR TO ANY GRADING OPERATIONS IN THE AREA THAT IS TO BE PROTECTED. THE PERIMETER EROSION CONTROL BARRIER SHALL BE MAINTAINED THROUGHOUT THE CONSTRUCTION PERIOD AND REMOVED IN CONJUNCTION WITH THE FINAL GRADING AND SITE STABILIZATION.
2. THE PERIMETER EROSION CONTROL BARRIER SHALL BE 100% BIODEGRADABLE.
3. SUBMIT PRODUCT DATA AND SHOP DRAWINGS TO ENGINEER OF RECORD FOR APPROVAL.
4. PERIMETER EROSION CONTROL BARRIER ENDS SHALL OVERLAP AT LEAST 18" FOR CONTINUED PERIMETER PROTECTION.
5. SEE PLANS FOR TEMPORARY CONSTRUCTION FENCE LOCATIONS.

PERIMETER EROSION BARRIER (SPECIAL)
WITH TEMPORARY FENCE (INSTALLED WITHIN FOREST PRESERVE TEMP. EASEMENT)



Specification Sheet
SediMax-FR™ (Filtration Roll)

DESCRIPTION

SediMax-FR™ shall be a machine-produced 100% biodegradable sediment filtration system.

SediMax-FR shall be composed of 70% straw and 30% coconut fiber matrix evenly distributed over the entire area of the bottom netting. The SediMax-FR shall consist of a bottom netting and a 2 ft. (0.61 m) top netting that covers the matrix material on the "splash apron" of the SediMax-FR system. The netting shall be constructed from 100% biodegradable woven natural organic fiber netting. The netting shall consist of machine directional strands formed from two intertwined yarns with cross directional strands interwoven through the twisted machine strands (commonly referred to as a Leno weave) to form an approximate (0.50 x 1.0 inch (1.27 x 2.54 cm) mesh. The blanket shall be sewn together on 1.50 inch (3.81 cm) centers with biodegradable thread.

Each SediMax-FR shall yield a structure 50 linear feet (15.2 m) in length, with an approximate finished diameter of 9 inches (0.23 m). The diameter of the finished structure may be increased to meet individual project specifications by spreading loose straw, pine needles, wood chips, grass clippings, etc. across the width of the SediMax-FR before rolling edge to edge.

Material Content

| | | |
|--------|-------------------|-------------------------------|
| Matrix | 70% Straw Fiber | 1.225 lbs/sy (0.665 kg/sm) |
| | 30% Coconut Fiber | 0.525 lbs/sy (0.285 kg/sm) |

Netting

| | |
|---|---------------------------------------|
| Bottom: Leno woven 100% biodegradable natural organic Fiber | 9.30 lbs/1000 sf (4.50 kg/ 100 sm) |
| Top: 2 ft (0.21 m) strip covering the "splash apron", Leno weave jute netting | 9.30 lbs/1000 sf (4.5 kg/100 sm) |

Thread Biodegradable

Physical Specifications

| | |
|----------------|---------------------|
| Width | 6.67 ft (2.03 m) |
| Length | 50.00 ft (15.25 m) |
| Weight +/- 10% | 65.00 lbs (29.5 kg) |
| Stitch Spacing | 1.5 in (3.81 cm) |
| Diameter | 9.00 in. (0.23 m) |



Western Green
4609 E. Boonville-New Harmony Rd.
Evansville, IN 47725
nagreen.com
800-772-2040

©2019, North American Green is a registered trademark from Western Green. Certain products and/or applications described or illustrated herein are protected under one or more U.S. patents. Other U.S. patents are pending, and certain foreign patents and patent applications may also exist. Trademark rights also apply as indicated herein. Final determination of the suitability of any information or material for the use contemplated, and its manner of use, is the sole responsibility of the user. Printed in the U.S.A.

EC_SMAX_MP05_SEDI_FR_1.19

STATE OF ILLINOIS
DEPARTMENT OF TRANSPORTATION

FOREST WAY DRIVE OVER DITCH
EROSION CONTROL AND LANDSCAPING NOTES AND DETAILS

SCALE: SHEET OF SHEETS STA. TO STA.

| F.A.P RTE. | SECTION | COUNTY | TOTAL SHEETS | SHEET NO. |
|--------------------|--------------------|----------|------------------|--------------|
| 0092 | (048-112-15D) CR24 | COOK | 46 | 17 |
| CONTRACT NO. 62W72 | | | | |
| | | ILLINOIS | FED. AID PROJECT | |

DATE PLOTTED = 9/4/2025 4:21:03 PM
PEN TABLE = 0021693.08.tbl
PLOT CONFIG = CGPLOT.plt
PLOT FILE = \\C:\Users\askonic\Documents\Projects\IL-DOT\DOT16931693\08\CADD Data\Sheet\erlin Contral\0021693.07_62W72-SHT-ESC-DET-03.dgn



| | | |
|------------------------------|----------------|-----------|
| USER NAME = askonic | DESIGNED TBH | REVISED - |
| | DRAWN AS | REVISED - |
| PLOT SCALE = 41,667' = 1 in. | CHECKED NF | REVISED - |
| PLOT DATE = 8/19/2025 | DATE 7/25/2025 | REVISED - |

STATE OF ILLINOIS
DEPARTMENT OF TRANSPORTATION

FOREST WAY DRIVE OVER DITCH
EROSION CONTROL AND LANDSCAPING NOTES AND DETAILS

SCALE: SHEET OF SHEETS STA. TO STA.

| F.A.P. RTE. | SECTION | COUNTY | TOTAL SHEETS | SHEET NO. |
|---------------------------|--------------------|--------|--------------|-----------|
| 0092 | (048-112-15D) GR24 | COOK | 46 | 19 |
| CONTRACT NO. 62W72 | | | | |
| ILLINOIS FED. AID PROJECT | | | | |

STABILIZED CONSTRUCTION ENTRANCE PLAN

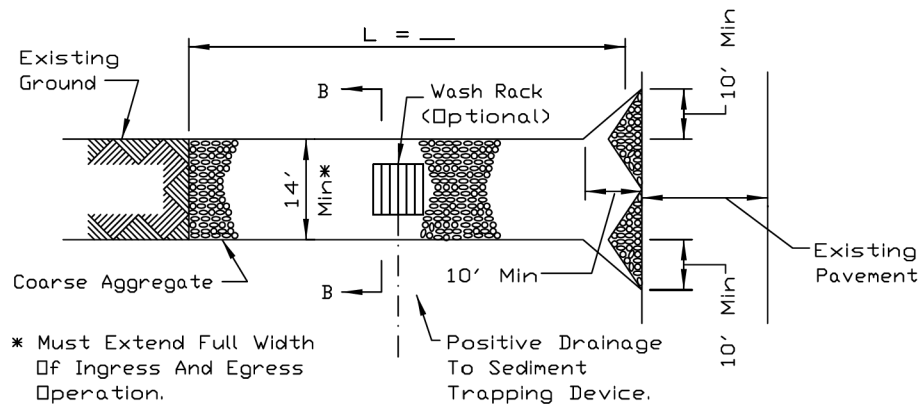

PLAN VIEW

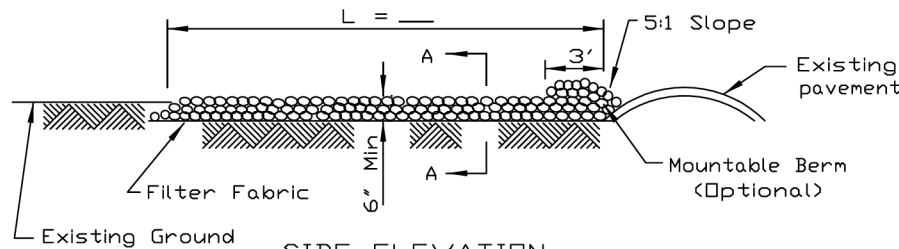

SIDE ELEVATION

NOTES:

1. Filter fabric shall meet the requirements of material specification 592 GEOTEXTILE, Table I or 2, Class I, II or IV and shall be placed over the cleared area prior to the placing of rock.
2. Rock or reclaimed concrete shall meet one of the following IDOT coarse aggregate gradation, CA-1, CA-2, CA-3 or CA-4 and be placed according to construction specification 25 ROCKFILL using placement Method 1 and Class III compaction.
3. Any drainage facilities required because of washing shall be constructed according to manufacturers specifications.
4. If wash racks are used they shall be installed according to the manufacturer's specifications.

| | |
|-----------|------|
| REFERENCE | |
| Project | |
| Designed | Date |
| Checked | Date |
| Approved | Date |



| |
|-------------------|
| STANDARD DWG. NO. |
| IL-630 |
| SHEET 1 OF 2 |
| DATE 8-18-94 |

STABILIZED CONSTRUCTION ENTRANCE PLAN

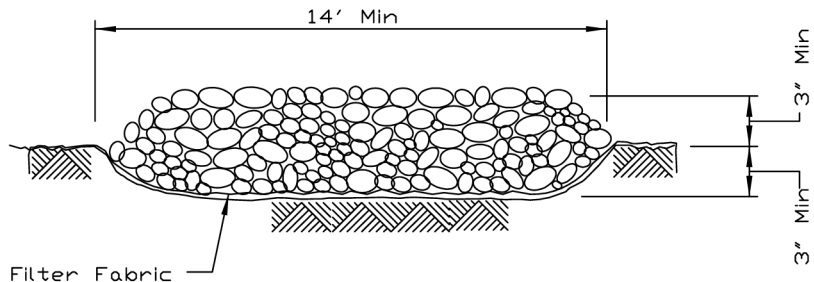

SECTION A-A

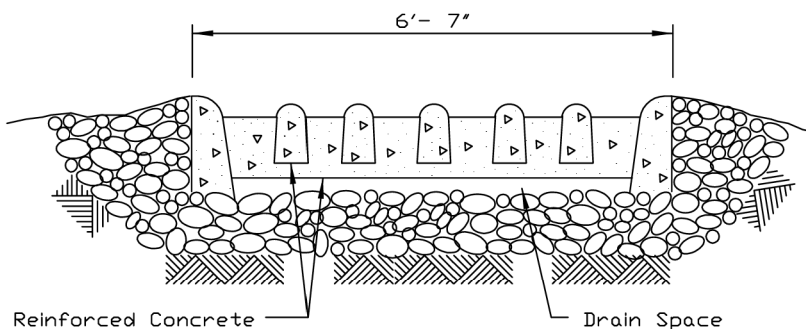

SECTION B-B

| | |
|-----------|------|
| REFERENCE | |
| Project | |
| Designed | Date |
| Checked | Date |
| Approved | Date |



| |
|-------------------|
| STANDARD DWG. NO. |
| IL-630 |
| SHEET 2 OF 2 |
| DATE 8-18-94 |

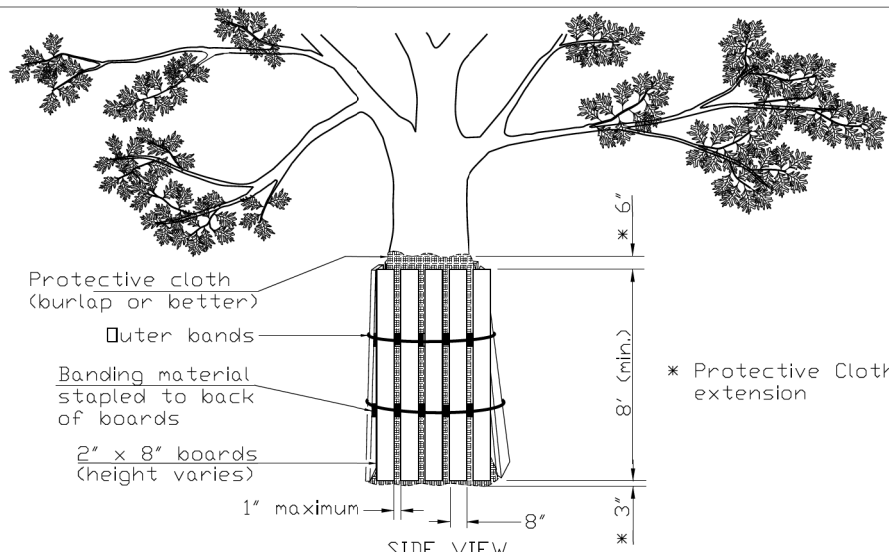

SIDE VIEW

Notes

1. The contractor shall provide 2" x 8" boards banded continuously around each trunk with a protective cloth (such as burlap or better) placed between the boards and the tree to prevent scarring of the tree being protected. The height of the boards is variable due to height of tree being protected. Trees to be protected shall be shown in the plans or designated by the Professional Forester or Certified Arborist.
2. The protective cloth shall extend past both the top and bottom of the boards as shown in the detail. Width of wrap material varies. For fabric that does not meet the required height, fabric shall overlap a minimum of 6" and shall be spliced to avoid slippage.

| | |
|-----------|------|
| REFERENCE | |
| Project | |
| Designed | Date |
| Checked | Date |
| Approved | Date |



| |
|-------------------|
| STANDARD DWG. NO. |
| IUM-690-C |
| SHEET 1 OF 1 |
| DATE 09-14-2017 |

TREE PROTECTION
(PAID FOR AS TEMPORARY FENCE)