

ADVANCED WARNING SYSTEM FOR SHARED USE CROSSING ON HOWARD STREET EAST OF NORDICA AVENUE

FOR THE VILLAGE OF NILES, ILLINOIS LOCATION MAP

STANDARD SYMBOLS

EXISTING	FEATURE	PROPOSED
BM/TBM □	BENCHMARK	BM/TBM □
---	CONCRETE R.O.W. MONUMENT	---
---	R.O.W. LINE	---
---	STORM SEWER	---
○	STORM SEWER MANHOLE	○
□	CATCH BASIN	□
○ C.O.	INLET	○ C.O.
---	CLEAN OUT	---
---	SANITARY SEWER	---
---	SANITARY FORCEMAIN	---
---	COMBINED SEWER	---
○	SANITARY SEWER MANHOLE	○
○	WATER VAULT	○
○	VALVE BOX	○
W	WATERMAIN	W
△	FIRE HYDRANT	△
△ GAS	GAS MANHOLE	△ GAS
△	GAS VALVE	△
G	GAS MAIN	G
T	TELEPHONE LINES	T
□ IBT	IBT BOX	□ IBT
□ IBT	IBT MANHOLE	□ IBT
E	ELECTRIC LINES	E
○ ELEC.	ELECTRIC MANHOLE	○ ELEC.
U	UTILITY POLE	U
S	SIGN	S
L	LIGHT STANDARD	L
F	FENCE	F
T	TREE	T
S	SHRUB	S
857	CONTOUR LINE	857
x 854.7	SPOT GRADE	x 857.4
---	HEADWALL	---
---	FLARED END SECTION	---
---	CULVERT	---
---	SWALE	---
•	PROPERTY PIN	•
RIM INV.	STORM SEWER STRUCTURE ELEVATION	RIM INV.
RIM INV.	SANITARY SEWER STRUCTURE ELEVATION	RIM INV.
RIM T.O.P. I.T.O.P.	WATER MAIN STRUCTURE ELEVATION	RIM T.O.P. I.T.O.P.

EXISTING UTILITIES: WHEN THE PLANS OR SPECIAL PROVISIONS INCLUDE INFORMATION PERTAINING TO THE LOCATION OF UNDERGROUND UTILITY FACILITIES, SUCH INFORMATION REPRESENTS ONLY THE OPINION OF THE ENGINEER AS TO THE LOCATION OF SUCH UTILITIES AND IS ONLY INCLUDED FOR THE CONVENIENCE OF THE BIDDER. THE ENGINEER AND OWNER ASSUME NO RESPONSIBILITY WHATEVER IN RESPECT TO THE SUFFICIENCY OR ACCURACY OF THE INFORMATION SHOWN ON THE PLANS RELATIVE TO THE LOCATION OF UNDERGROUND UTILITY FACILITIES OR THE MANNER IN WHICH THEY ARE TO BE REMOVED OR ADJUSTED. IT SHALL BE THE CONTRACTOR'S RESPONSIBILITY TO DETERMINE THE ACTUAL LOCATION OF ALL SUCH FACILITIES. HE SHALL ALSO OBTAIN FROM THE RESPECTIVE UTILITY COMPANIES, DETAILED INFORMATION RELATIVE TO THE LOCATION OF THEIR FACILITIES AND THE WORKING SCHEDULES OF THE UTILITY COMPANIES FOR REMOVING OR ADJUSTING THEM.

CONTRACTOR IS RESPONSIBLE FOR CONTACTING J.U.L.I.E. AT 1-800-892-0123 AND MUST ACQUIRE A DIG NUMBER A MINIMUM OF 72 HOURS PRIOR TO ANY WORK BEING DONE.



NOTE: CONSTRUCTION MEANS, METHODS AND JOB SITE SAFETY IS THE SOLE AND EXCLUSIVE RESPONSIBILITY OF THE CONTRACTOR

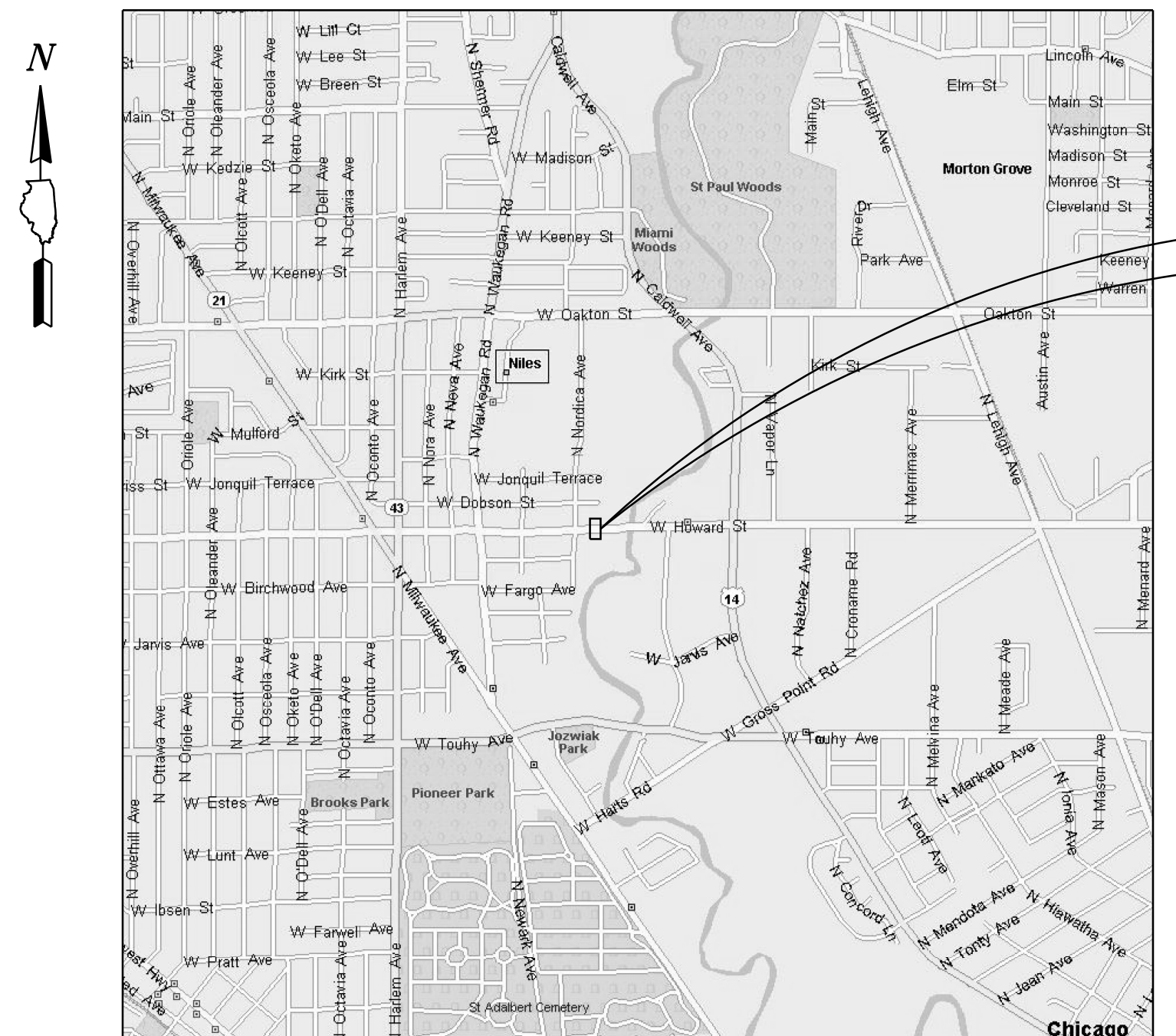

PROJECT LOCATION
HOWARD STREET
NILES, ILLINOIS

HIGHWAY STANDARDS

- 424001-07 PERPENDICULAR CURB RAMP FOR SIDEWALKS
- 606001-05 CONCRETE CURB TYPE B AND COMBINATION CONCRETE CURB AND GUTTER
- 701006-05 OFF-RD OPERATIONS, 2L, 2W, 15' (4.5 m) TO 24" (600 mm) FROM PAVEMENT EDGE
- 701011-04 OFF-RD MOVING OPERATIONS 2L, 2W, DAY ONLY
- 701101-04 OFF-RD OPERATIONS, MULTILANE 15' (4.5 m) TO 24" (600 mm) FROM PAVEMENT EDGE
- 701301-04 LANE CLOSURE 2L, 2W SHORT TIME OPERATIONS
- 701606-09 URBAN LANE CLOSURE MULTILANE, 2W WITH MOUNTABLE MEDIUM
- 701801-05 SIDEWALK, CORNER OR CROSSWALK CLOSURE
- 701901-03 TRAFFIC CONTROL DEVICES
- TC-13 DISTRICT ONE TYPICAL PAVEMENT MARKING

SHEET INDEX

1. TITLE SHEET
2. TRAIL CROSSING
3. TRAIL CROSSING - DETAIL
4. DETAILS

COORDINATING/PERMITTING AGENCIES:

Village of Niles Engineering Department	847-588-7900
Forest Preserve District of Cook County (FPDCC)	708-771-1180

UTILITY AGENCIES:

Commonwealth Edison Co.	847-291-3337
TCI Northern Illinois	847-625-1194
Ameritech	847-506-8716
North Shore Gas Co.	847-263-4670

TOPOGRAPHIC SURVEY BY:

Gewalt Hamilton Associates, Inc.
850 Forest Edge Drive
Vernon Hills, Illinois 60061
Telephone: 847-478-9700

SIGNED: _____
DANIEL P. BRINKMAN, EXP. 11/30/2015
DATE: _____
DANIEL P. BRINKMAN
062-055293
LICENSED PROFESSIONAL ENGINEER
OF ILLINOIS

NOT FOR CONSTRUCTION

GHA GEWALT HAMILTON ASSOCIATES, INC.
850 Forest Edge Drive ■ Vernon Hills, IL 60061
TEL 847.478.9700 ■ FAX 847.478.9701

COPYRIGHT NOTICE
This drawing is the property of Gewalt-Hamilton Assoc., Inc. and is not to be used for any purpose other than the specific project and site named herein, and cannot be reproduced in any manner without the express written permission from Gewalt-Hamilton Associates, Inc.

TITLE SHEET
NILES MID BLOCK PEDESTRIAN CROSSING
HOWARD STREET
VILLAGE OF NILES, ILLINOIS

NO.	BY	DATE	REVISION	NO.	BY	DATE	REVISION

FILE: 3645.230_Plan set.dgn	SHEET NUMBER: 1
DRAWN BY: PJS DATE: 7/21/14	GHA PROJECT # 3645.230
CHECKED BY: DPB DATE: 7/21/14	SCALE: N.T.S.
	OF 4 SHEETS

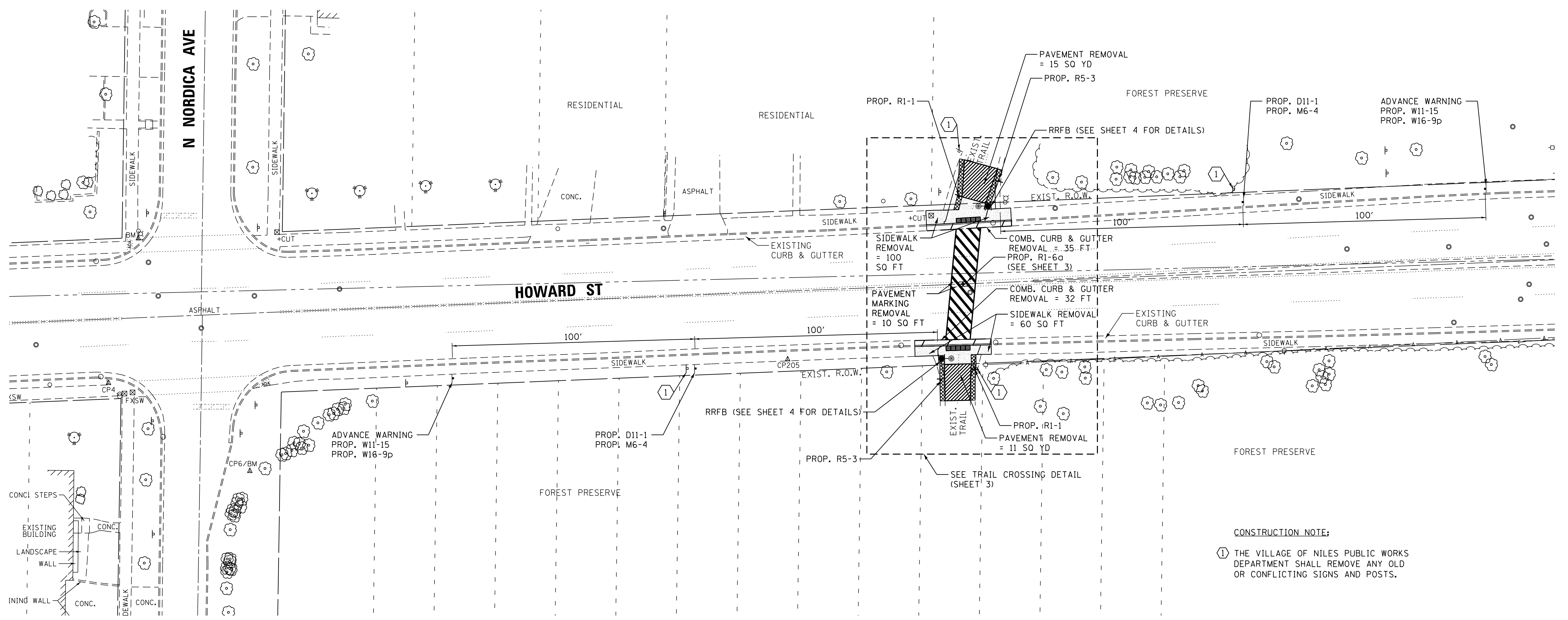
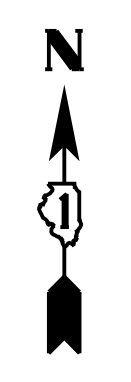

CONSTRUCTION NOTE:
 ① THE VILLAGE OF NILES PUBLIC WORKS DEPARTMENT SHALL REMOVE ANY OLD OR CONFLICTING SIGNS AND POSTS.



GHA GEWALT HAMILTON ASSOCIATES, INC.
 850 Forest Edge Drive ■ Vernon Hills, IL. 60061
 TEL 847.478.9700 ■ FAX 847.478.9701

COPYRIGHT NOTICE
 This drawing is the property of Gewalt-Hamilton Assoc., Inc. and is not to be used for any purpose other than the specific project and site named herein, and cannot be reproduced in any manner without the express written permission from Gewalt-Hamilton Associates, Inc.

TRAIL CROSSING
NILES MID BLOCK PEDESTRIAN CROSSING
HOWARD STREET
VILLAGE OF NILES, ILLINOIS

NO.	BY	DATE	REVISION	NO.	BY	DATE	REVISION

FILE: 3645.230_Plan set.dgn
 DRAWN BY: PJS GHA PROJECT # 3645.230
 DATE: 7/21/14
 CHECKED BY: DPB SCALE: 1"=20'
 DATE: 7/21/14
 SHEET NUMBER: **2**
 OF 4 SHEETS

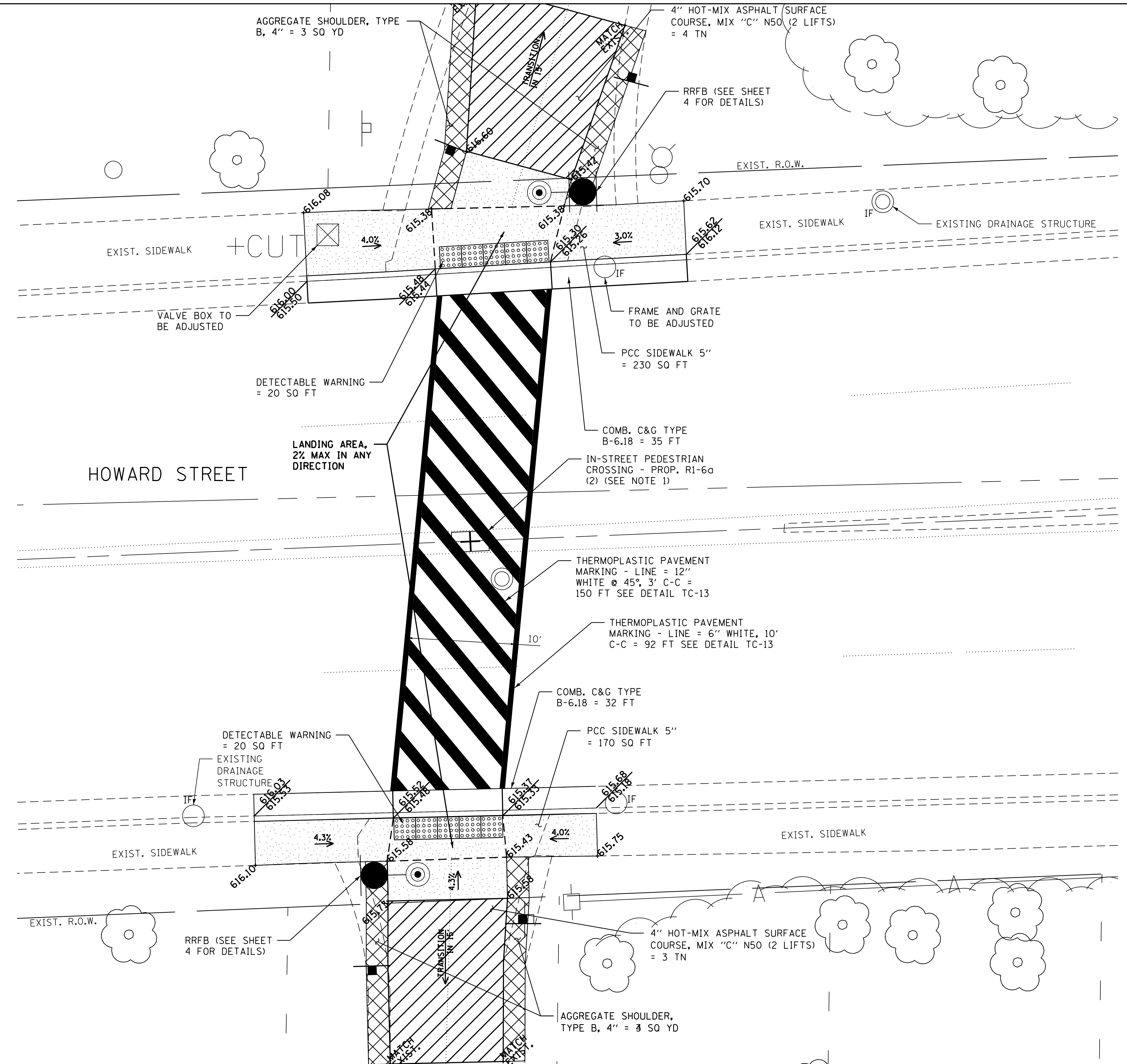
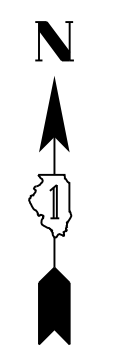

CONSTRUCTION NOTE:

① THE CONTRACTOR SHALL PROVIDE THE PORTABLE RUBBER BASE TO MOUNT THE R-16a (2) SIGNS ON. THE BASE SHALL BE APPROVED BY THE VILLAGE OF NILES AND SHALL BE CONSIDERED INCIDENTAL TO THE COST OF THE SIGN PANEL - TYPE 1.

IF = INLET FILTER

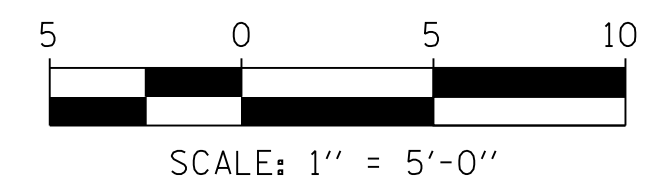

GHA GEWALT HAMILTON ASSOCIATES, INC.
 850 Forest Edge Drive ■ Vernon Hills, IL. 60061
 TEL 847.478.9700 ■ FAX 847.478.9701

COPYRIGHT NOTICE
 This drawing is the property of Gewalt-Hamilton Assoc., Inc. and is not to be used for any purpose other than the specific project and site named herein, and cannot be reproduced in any manner without the express written permission from Gewalt-Hamilton Associates, Inc.

TRAIL CROSSING DETAIL
NILES MID BLOCK PEDESTRIAN CROSSING
HOWARD STREET
VILLAGE OF NILES, ILLINOIS

NO.	BY	DATE	REVISION	NO.	BY	DATE	REVISION

FILE: 3645.230.Plan set.dgn	SHEET NUMBER:
DRAWN BY: PJS	GHA PROJECT #
DATE: 7/21/14	3645.230
CHECKED BY: DPB	SCALE:
DATE: 7/21/14	1"=5'
	OF 4 SHEETS

SUMMARY OF QUANTITIES		LOCATION	NILES ROAD MID-BLOCK CROSSING
CODE NO.	ITEM	UNIT	TOTAL
40603310	HOT-MIX ASPHALT SURFACE COURSE, MIX "C", N50	TON	7
42400200	PORTLAND CEMENT CONCRETE SIDEWALK 5 INCH	SO FT	400
42400800	DETECTABLE WARNINGS	SO FT	40
44000100	PAVEMENT REMOVAL	SO YD	26
44000500	COMBINATION CURB AND GUTTER REMOVAL	FOOT	67
44000600	SIDEWALK REMOVAL	SO FT	160
48101498	AGGREGATE SHOULDER, TYPE B, 4"	SO YD	7
60266600	VALVE BOX TO BE ADJUSTED	EACH	1
60300305	FRAMES AND LIDS TO BE ADJUSTED	EACH	2
60605000	COMBINATION CONCRETE CURB AND GUTTER, TYPE B-6.24	FOOT	67
67100100	MOBILIZATION	L SUM	1
70102625	TRAFFIC CONTROL AND PROTECTION, STANDARD 701606	L SUM	1
70102640	TRAFFIC CONTROL AND PROTECTION, STANDARD 701801	L SUM	1
72000100	SIGN PANEL - TYPE 1	SO FT	80.50
72900200	METAL POST - TYPE B	FOOT	120
78000400	THERMOPLASTIC PAVEMENT MARKING - LINE 6"	FOOT	92
78000600	THERMOPLASTIC PAVEMENT MARKING - LINE 12"	FOOT	150
78300100	PAVEMENT MARKING REMOVAL	SO FT	10
87502500	TRAFFIC SIGNAL POST, GALVANIZED STEEL 16 FT.	EACH	2
87800100	CONCRETE FOUNDATION, TYPE A	FOOT	8
88800100	PEDESTRIAN PUSH-BUTTON	EACH	2
XX007021	PEDESTRIAN ACTIVATED CROSSWALK WARNING SYSTEM	EACH	1

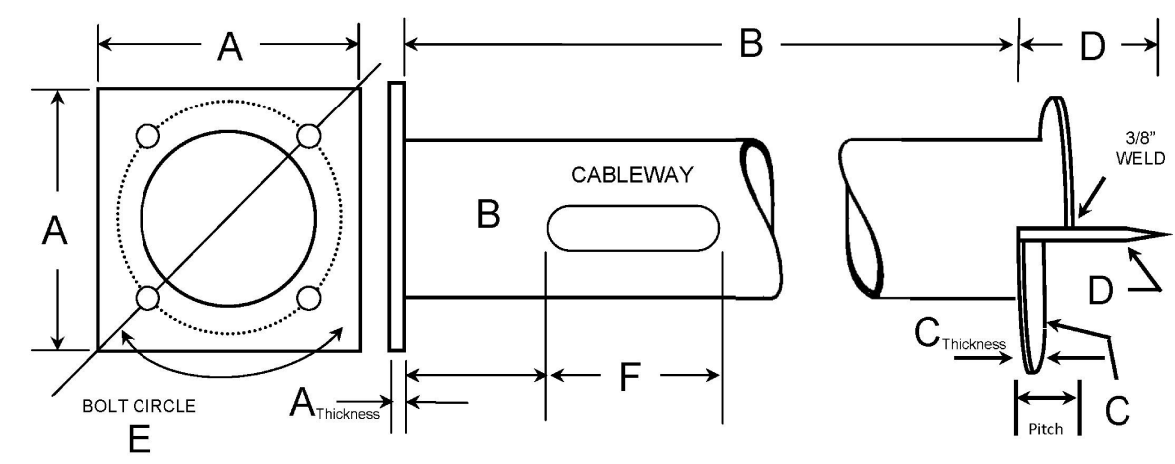

- SLSF-10-8
- A BASEPLATE: 14" x 14" x 1" Thick
With 2 Notches to Indicate Cableways
 - B BODY: 10-3/4" OD Sch 20 .250 Wall 8 Ft Long
 - C HELIX PLATE: 3/8" x 15" OD with 3" Pitch
 - D PILOT POINT: 1-1/4" OD x 9" Long
 - E BOLT CIRCLE DESIGN: Bolt Circle 15"
Four 1-1/16" Diameter Holes
 - F CABLEWAY: 2-1/2" x 27" Starting 15" from top plate -- Double Sided
- CONNECTING HARDWARE: 1 set of 4 each 1" x 4" Hex Bolts
with LW/FW/HH
- HELIX IS HOT DIP GALVANIZED PER ASTM A-123 & AASHTO M-111

**HELIX FOUNDATION
ALTERNATE #1**

HOT-MIX ASPHALT MIXTURE REQUIREMENTS		
MIXTURE TYPE	AIR VOIDS @ Ndes	
FULL DEPTH PAVEMENT - BIKE PATH		
HOT MIX ASPHALT SURFACE COURSE, MIX 'C', N50 (IL 9.5 mm)	4% @ 50 GYR	
HOT-MIX ASPHALT BINDER COURSE, IL-19.0, N50	4% @ 50 GYR	
PATCHING - PRIVATE / LOCAL ROW		
HOT MIX ASPHALT SURFACE COURSE, MIX 'D', N50 (IL 9.5 mm)	4% @ 50 GYR	
CLASS D PATCHES (HMA BINDER IL-19 mm)	4% @ 50 GYR	
PATCHING - IDOT / LCDOT ROW		
HMA SURFACE COURSE, MIX 'D', N70, (IL 9.5 mm)	4% @ 70 GYR	

THE UNIT WEIGHT TO CALCULATE ALL HMA SURFACE MIXTURE QUANTITIES IS 112 LBS/SY/IN

THE "AC TYPE" FOR NON-POLYMERIZED HMA SHALL BE "PG 64-22" UNLESS OTHERWISE MODIFIED BY DISTRICT ONE SPECIAL PROVISIONS.

FOR "PERCENT OF RAP" SEE DISTRICT ONE SPECIAL PROVISIONS.



W11-15
36"X36"
(FLUORESCENT
YELLOW GREEN)

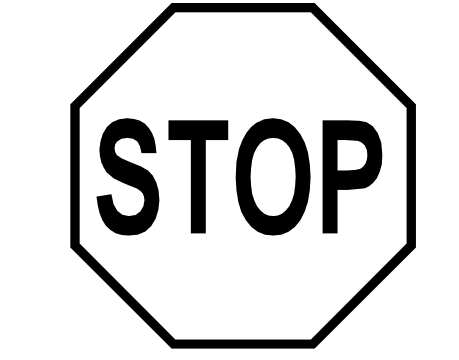

R1-1
24"X24"



D11-1
24"X18"



W16-9P
30"X18"
(FLUORESCENT
YELLOW GREEN)

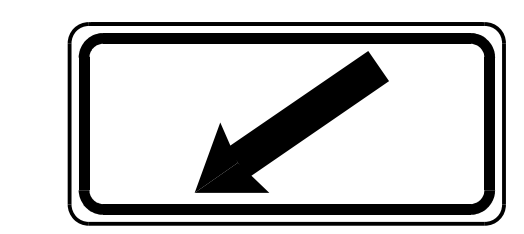

W16-7P
30"X18"
(FLUORESCENT
YELLOW GREEN)



R5-3
24"X24"

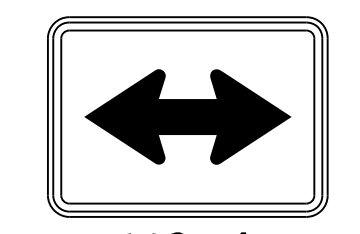

M6-4
12"X9"

SIGN LEGEND



FOR



WITHIN
CROSSWALK

R1-6a
12"X36"
(FLUORESCENT
YELLOW GREEN)

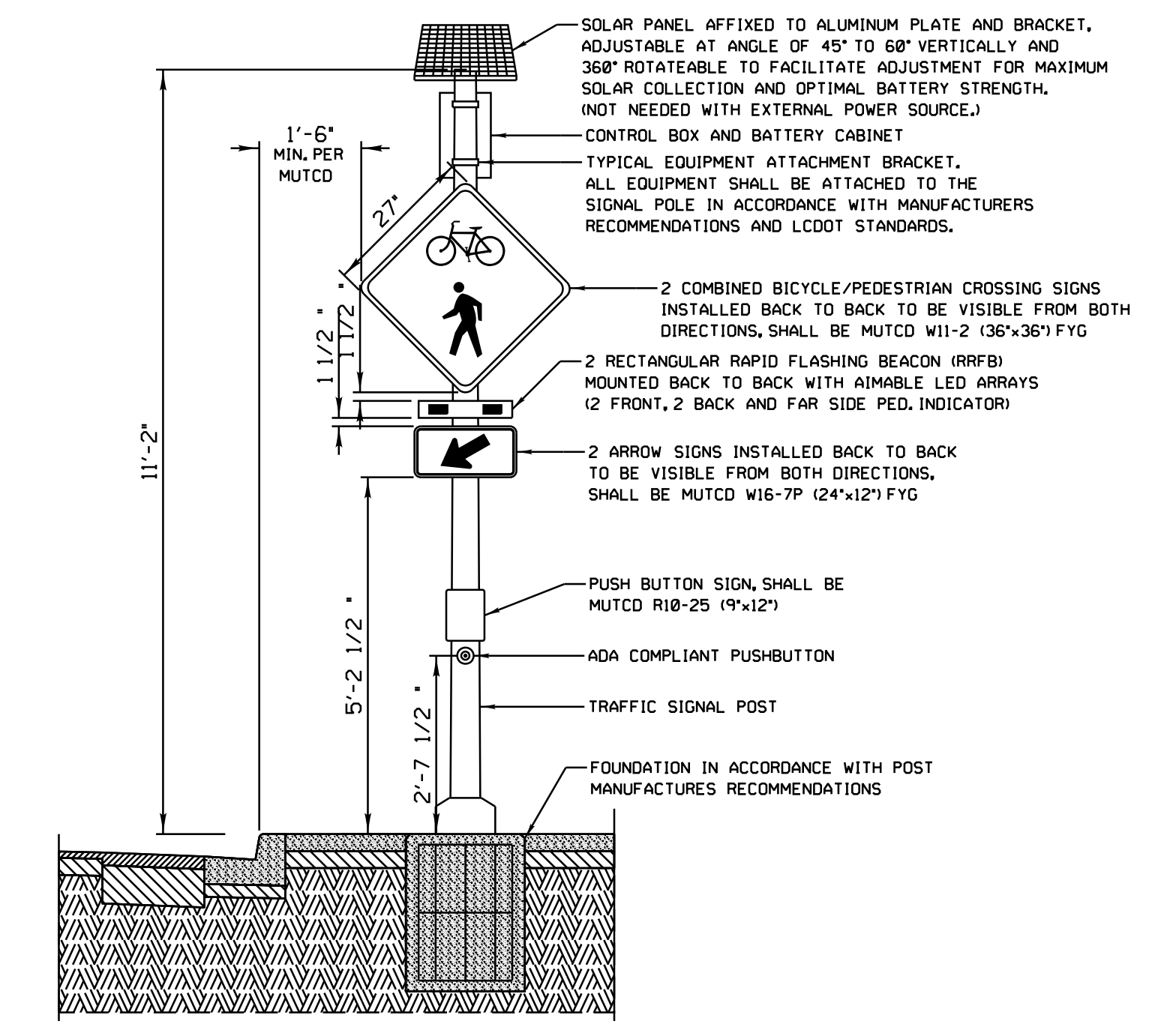

**RECTANGULAR RAPID FLASHING BEACON (RRFB) SYSTEM
PEDESTRIAN ACTIVATED CROSSWALK WARNING SYSTEM**

NO.	BY	DATE	REVISION	NO.	BY	DATE	REVISION