



ISSUE	DATE
1	2/18/22



A022SNF PROPOSED DETAILS

DESCRIPTION	QUANTITY
MANHOLE	-
PFP	-
FLOWER POT	-
HANDHOLE	-
BORE PIT/TURN PIT/DIG PIT	6



AT&T PROJECT: A022SNF  
 ENGINEER: SEAN NOWITZKI  
 TEL # 708-396-2132  
 QUARTER SECTION: NW-7  
 MUNICIPALITY: WILLOW SPRINGS  
 TOWNSHIP: PALOS  
 WIRE CENTER: SUMMIT  
 COUNTY OF: COOK  
 DWG 1 OF 5 REV. NO. \_\_\_\_\_

**PHYSICAL ADDRESS:-**  
**9550 S 119TH AVE, WILLOW SPRINGS, IL 60480**

PREPARED BY: J.JINDAL  
 CHC CONSULTING  
 1845 W. Orangewood Ave., Suite 300  
 Orange, CA 92868  
 (949) 250-0004 / FAX (949) 250-0006

GENERAL CONSTRUCTION NOTES:

1. LOCATE ALL UNDERGROUND OBSTRUCTIONS PRIOR TO DIGGING  
CONTACT J.U.L.I.E. AT 8-1-1 TWO BUSINESS DAYS IN ADVANCE TO DIGGING
2. RESTORE ALL DISTURBED GROUNDS TO ORIGINAL OR BETTER CONDITION  
AS SOON AS POSSIBLE OR WITHIN TWO (2) WEEKS AFTER CONSTRUCTION IS COMPLETE.
3. AT&T CONTRACTOR TO PLACE CONDUIT NO LESS THAN 24" DEEP.
4. AT&T CONTRACTOR TO PROVIDE ALL BARRICADES AND WORK AREA PROTECTION.
5. AT&T CONTRACTOR IS REQUIRED TO KEEP ALL ROADWAY PAVEMENT, CURBS,  
GUTTERS AND STORM WATER COLLECTORS FREE OF MUD AND OTHER DEBRIS AT  
ALL TIMES DURING CONSTRUCTION.
6. ALL PROPOSED WORK IS IN EXISTING PUBLIC RIGHT OF WAY AND/OR UTILITY EASEMENT.
7. TUNNEL ALL TREES PER BUREAU OF FORESTRY GUIDELINES.

- CAUTION: VOLTAGE RANGES FROM 301V TO 15KV

- THIS PROJECT REQUIRES COORDINATION WITH UT: NA

# PERMIT PRINT



ISSUE	DATE
1	2/18/22

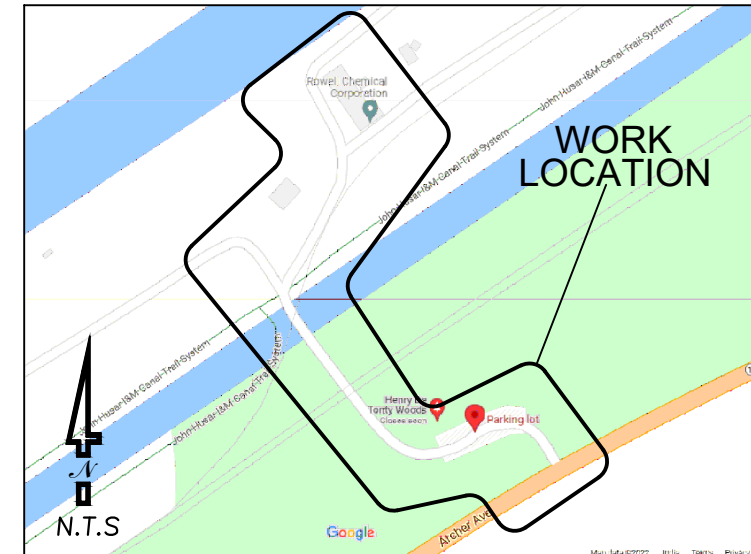

- 1 DIG 4'X4' PIT  
FOR CORE BORE MH #32
- 2 BORE AND PLACE 1-4" SCHEDULE 80 HDPE - 1293'  
EX. MH#32 TO BUILDING WALL

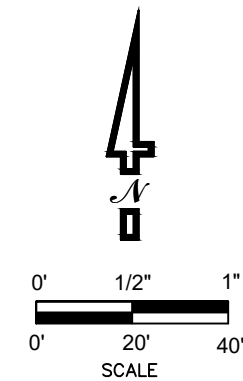
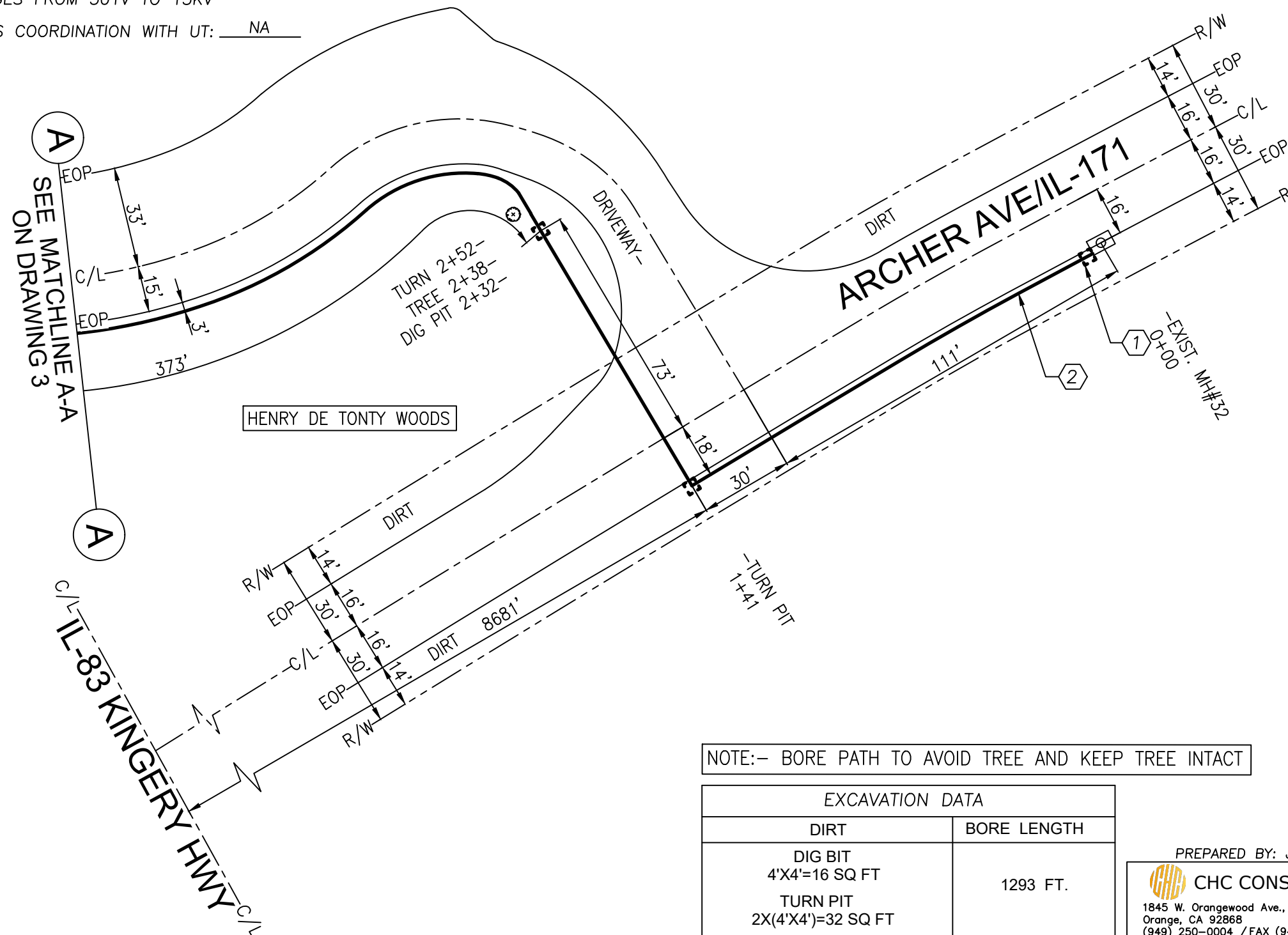

NOTE:- BORE PATH TO AVOID TREE AND KEEP TREE INTACT

EXCAVATION DATA	
DIRT	BORE LENGTH
DIG BIT 4'X4'=16 SQ FT	1293 FT.
TURN PIT 2X(4'X4')=32 SQ FT	

PREPARED BY: J.JINDAL  
 CHC CONSULTING  
 1845 W. Orangewood Ave., Suite 300  
 Orange, CA 92868  
 (949) 250-0004 / FAX (949) 250-0006

AT&T PROJECT: A022SNF  
 ENGINEER: SEAN NOWITZKI  
 TEL # 708-396-2132  
 QUARTER SECTION: NW-7  
 MUNICIPALITY: WILLOW SPRINGS  
 TOWNSHIP: PALOS  
 WIRE CENTER: SUMMIT  
 COUNTY OF: COOK

# PERMIT PRINT



ISSUE	DATE
1	2/18/22

GENERAL CONSTRUCTION NOTES:  
SEE DWG 2

(2) BORE AND PLACE 1-4" SCHEDULE 80 HDPE - 1293'  
EX. MH#32 TO BUILDING WALL

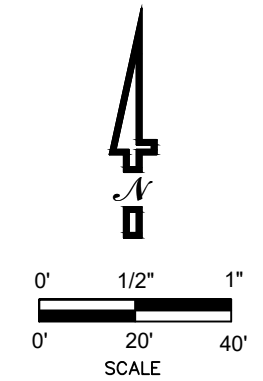
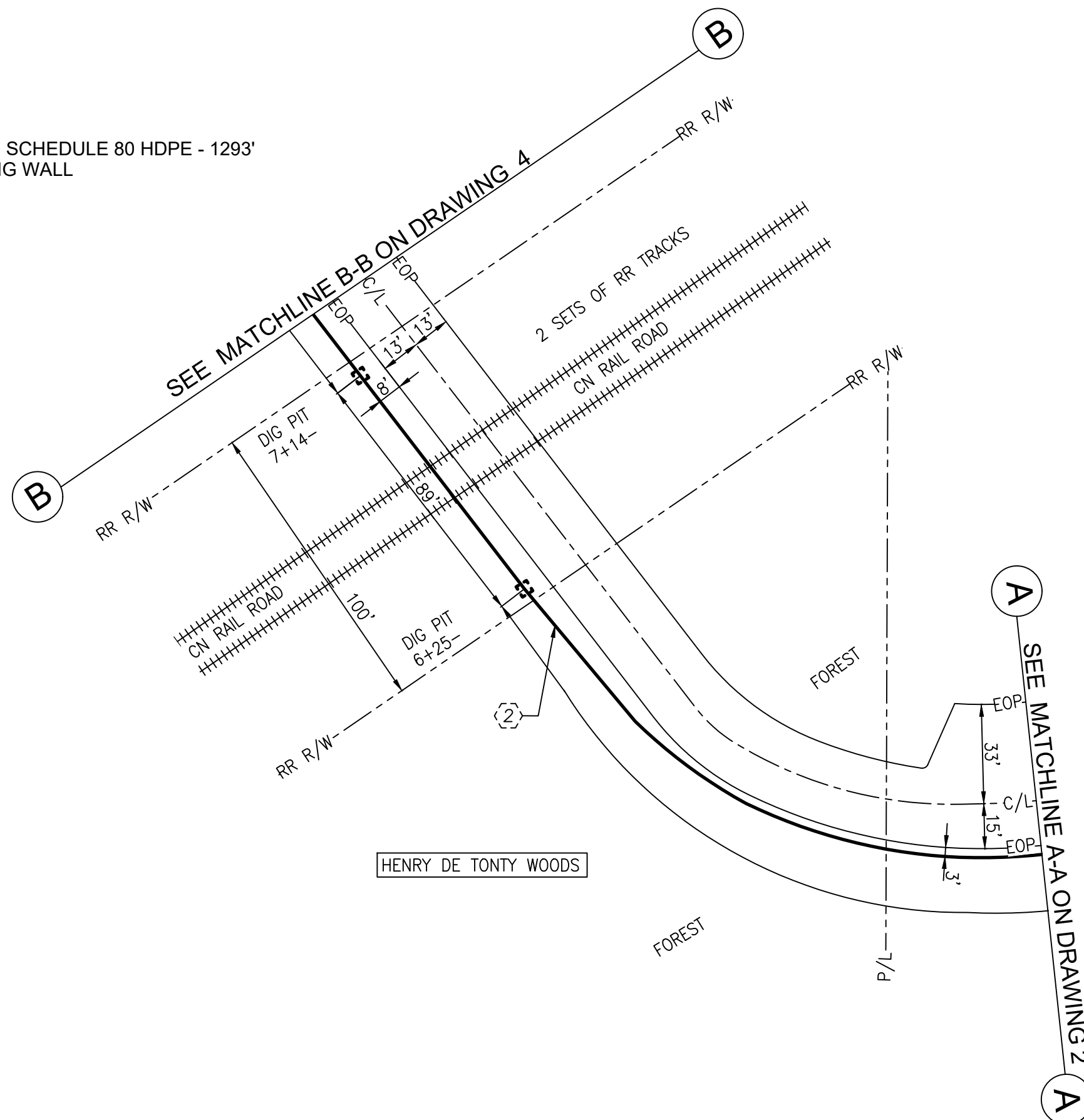

EXCAVATION DATA	
DIRT	BORE LENGTH
TURN PIT 2X(4'X4')=32 SQ FT	_____

PREPARED BY: J.JINDAL  
 CHC CONSULTING  
 1845 W. Orangewood Ave., Suite 300  
 Orange, CA 92868  
 (949) 250-0004 / FAX (949) 250-0006

AT&T PROJECT: A022SNF  
 ENGINEER: SEAN NOWITZKI  
 TEL # 708-396-2132  
 QUARTER SECTION: NW-7  
 MUNICIPALITY: WILLOW SPRINGS  
 TOWNSHIP: PALOS  
 WIRE CENTER: SUMMIT  
 COUNTY OF: COOK  
 DWG 3 OF 5 REV. NO. \_\_\_\_\_

# PERMIT PRINT



ISSUE	DATE
1	2/18/22

GENERAL CONSTRUCTION NOTES:  
SEE DWG 2

(2) BORE AND PLACE 1-4" SCHEDULE 80 HDPE - 1293'  
EX. MH#32 TO BUILDING WALL

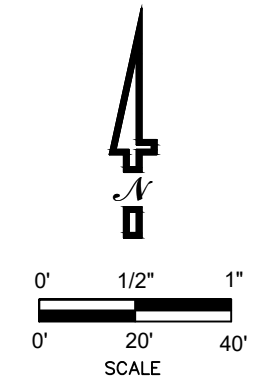
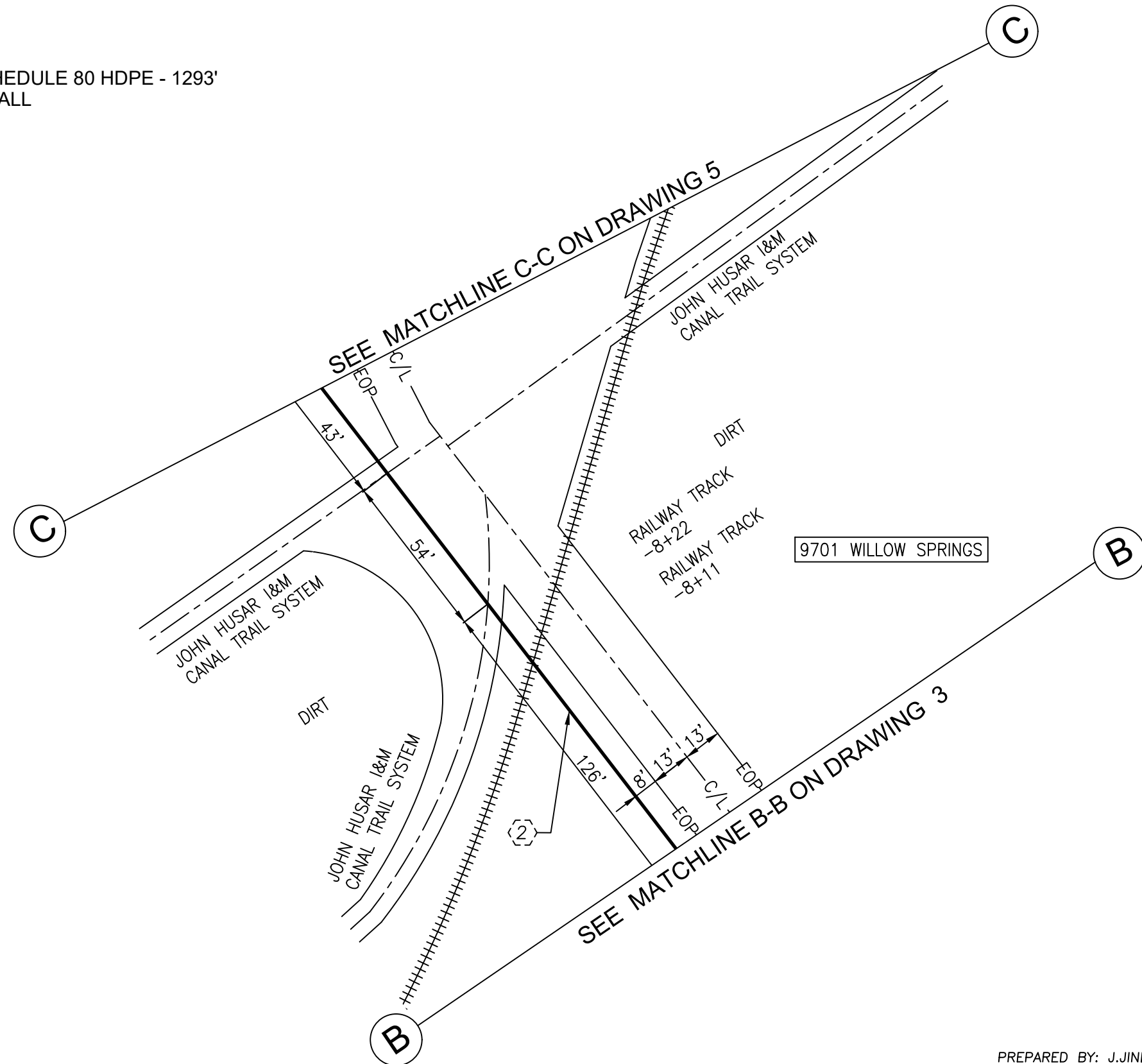

AT&T PROJECT: A022SNF  
 ENGINEER: SEAN NOWITZKI  
 TEL # 708-396-2132  
 QUARTER SECTION: NW-7  
 MUNICIPALITY: WILLOW SPRINGS  
 TOWNSHIP: PALOS  
 WIRE CENTER: SUMMIT  
 COUNTY OF: COOK

PREPARED BY: J.JINDAL  
 CHC CONSULTING  
 1845 W. Orangewood Ave., Suite 300  
 Orange, CA 92868  
 (949) 250-0004 / FAX (949) 250-0006

DWG 4 OF 5 REV. NO. \_\_\_\_\_

# PERMIT PRINT



ISSUE	DATE
1	2/18/22

GENERAL CONSTRUCTION NOTES:  
SEE DWG 2

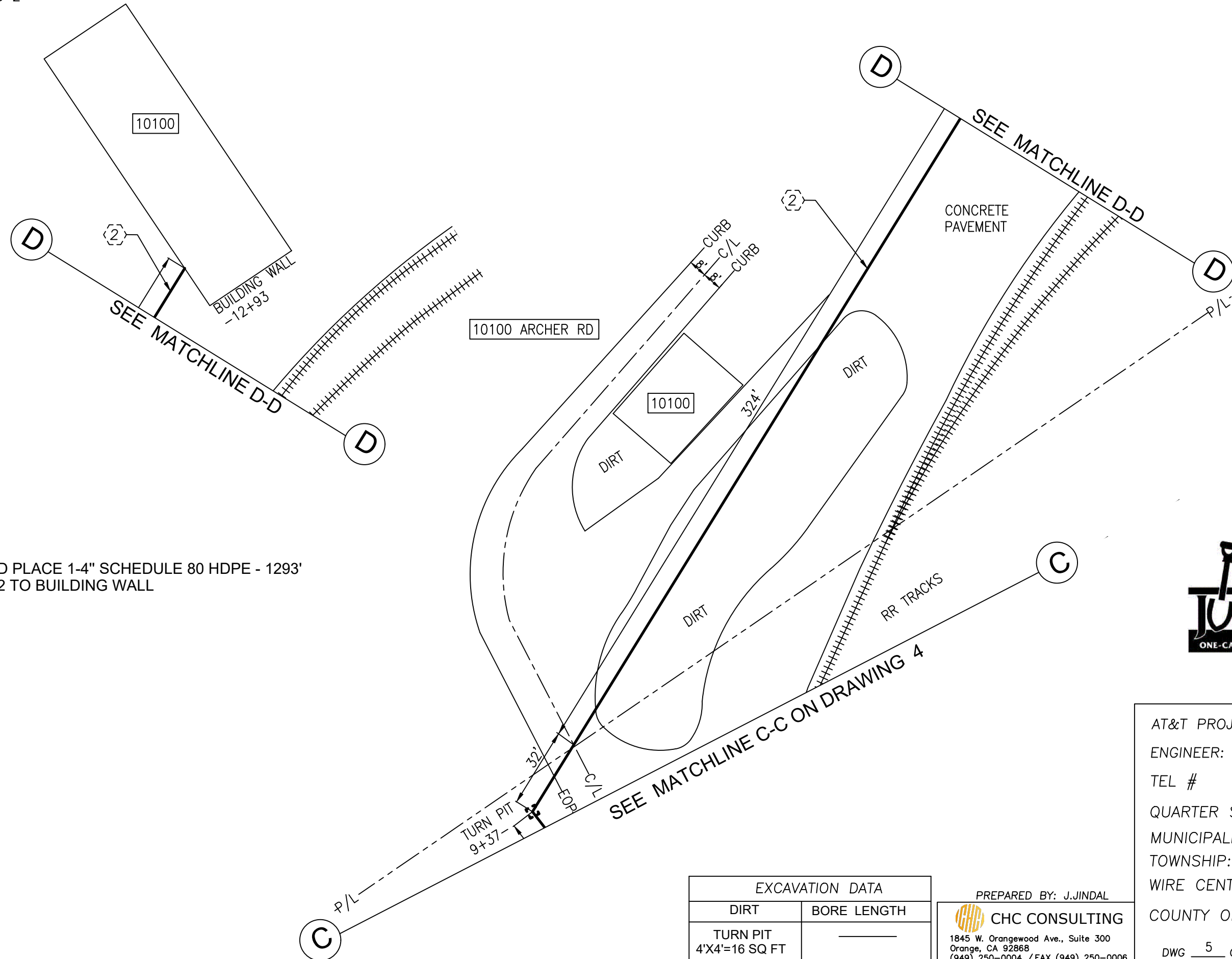

2 BORE AND PLACE 1-4" SCHEDULE 80 HDPE - 1293'  
EX. MH#32 TO BUILDING WALL

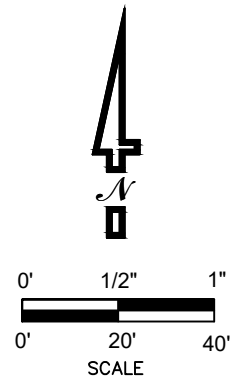

EXCAVATION DATA	
DIRT	BORE LENGTH
TURN PIT 4'X4'=16 SQ FT	—

PREPARED BY: J.JINDAL  
 CHC CONSULTING  
 1845 W. Orangewood Ave., Suite 300  
 Orange, CA 92868  
 (949) 250-0004 / FAX (949) 250-0006

AT&T PROJECT: A022SNF  
 ENGINEER: SEAN NOWITZKI  
 TEL # 708-396-2132  
 QUARTER SECTION: NW-7  
 MUNICIPALITY: WILLOW SPRINGS  
 TOWNSHIP: PALOS  
 WIRE CENTER: SUMMIT  
 COUNTY OF: COOK  
 DWG 5 OF 5 REV. NO. \_\_\_\_\_